



L&C

LABELING  
& CODING

## AURORA® MID-SPEED SHRINK SLEEVE APPLICATOR



### Dependable, steady-state operation at speeds up to 400 cpm

Aurora® shrink sleeve applicators are the mid-speed models in Axon's complete line of shrink sleeve systems. Aurora applicators provide dependable, steady-state production speeds up to 400 containers or multi-packs per minute. Aurora sleeve applicators are mandrel style machines that use servo motion control to deliver consistent, repeatable performance. Container changeovers are tool-less and require less than ten minutes depending on product sizes and shapes.

#### FEATURES AND BENEFITS

- **Size range flexibility** - Container or multipack diameters range from 1.2" (30 mm) to 4.9" (125 mm). Larger sizes are compatible with Aurora Wide applicators
- **Fast, tool-less size changeovers** - Size changeovers can be completed in less than ten minutes depending on container sizes and shapes
- **Servo motion control** - Dedicated servo drives for the feedscrew, film feed system, and cutting assembly deliver fast, accurate film feeding, registration and cutting
- **Intuitive, industry standard PackML programming & HMI user interfaces** - Consistent terminology, consistent screen displays and standardized program structures enhance ease of operation and maintenance
- **Auto-reversing cutter assembly & dual edge blades** - Dual edge cutting blades with a programmed auto-reversing cutting system extends blade life and reduces frequency of blade replacement
- **Electronic height adjustment** - Push-button system eliminates manual hand-crank height adjustments
- **Pivoting head assembly** - Film orientation is easily adjusted for non-round containers by rotating the sleeving head assembly up to 90°
- **Sealed-for-life bearings** - Lubrication free bearings and servo motion control make the Aurora a lubrication free machine

#### SHRINK APPLICATIONS

Like every Axon shrink sleeve applicator, Aurora offers the flexibility to perform multiple shrink applications. This flexibility makes Axon shrink sleeve applicators one of the best values in the industry.



FULL BODY



FULL BODY OVER THE CAP



TAMPER EVIDENT



TAMPER EVIDENT



PARTIAL



MULTIPACK



# AURORA® MID-SPEED SHRINK SLEEVE APPLICATOR

## TYPICAL PRODUCT SPECIFICATIONS

<b>Speed</b>	Up to 400 cpm
<b>Film Layflat Range</b>	50 mm – 200 mm (2.0" – 7.8")
<b>Container Diameter or Multi-Pack Cross Section</b>	30 mm – 125 mm (1.2" – 4.9")
<b>Applied Film Materials</b>	PVC, PETG, OPS, PLA
<b>Film Thickness</b>	40-70 microns (1.5 - 3.0 mil)
<b>Language Support</b>	English and Spanish Standard Other languages optional

<b>Controls</b>	Allen-Bradley Siemens
<b>HMI</b>	10" Allen-Bradley PanelView
<b>Servos</b>	Allen-Bradley Siemens
<b>Electrical Enclosure</b>	NEMA 12 - Standard NEMA 4X - Optional
<b>Machine Frame</b>	Extruded aluminum - Standard 304 Stainless steel - Optional
<b>Power</b>	480 volt, 3 Phase - Standard 230 volt, 3 Phase - Optional

## CONFIGURATION

Top view

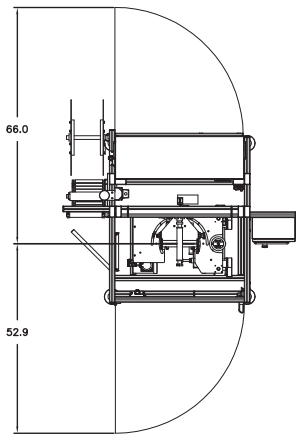

Front view

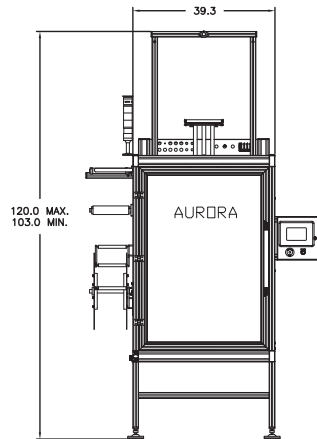

Dimensions are in inches

## OPTIONS

- **Automatic Speed Control** - Enables machine to automatically increase or decrease speeds based on line conditions
- **Print Registration** - Fiber optic sensor reads film registration marks so the PLC can calculate cut lengths to assure sleeve length accuracy
- **Vertical, Horizontal & T Perforators** - Add perforations to enhance ease of opening
- **Infeed Timing Screws** - Required for multipacks, certain container geometries
- **Product Spacers** - Precisely separate containers at the infeed to assure smooth production
- **Swing Arm HMI** - Provides flexible access to machine controls
- **Spare Parts Kit** - Recommended start-up parts inventory

## SHRINK APPLICATIONS



FULL BODY



FULL BODY OVER THE CAP



TAMPER EVIDENT



TAMPER EVIDENT



PARTIAL



MULTIPACK

©2018 ProMach Inc. ProMach reserves the right to change or discontinue specifications and designs shown in this brochure without notice or recourse  
PM-AX-SP101\_Axon\_Aurora\_0719v3