

## Top/side/bottom labeling

# Precision and fast cycle times

For many applications, absolutely precise labeling along with high repeatability is crucial. This is particularly important for technical and safety-related aspects. Electronic components with functional labels are only one example for it. But visual reasons also play an important role, such as decorative labels for fast-moving consumer goods. For these and other applications, the HERMA 500 MB ensures maximum precision in label transfer. And combines it with an overall very compact design for flexible integration into indexing production lines.

Separated and centered, the products are fed to the HERMA 500 MB. After the labeling start, the movable peel plate transports the label under the tamp pad of the transfer unit. The label on the tamp pad is then applied to the product by the transfer unit and with high precision and repeatability. This guarantees optimum results both on products with flat surfaces and on surfaces with raised or recessed areas. Even at up to 70 products per minute.

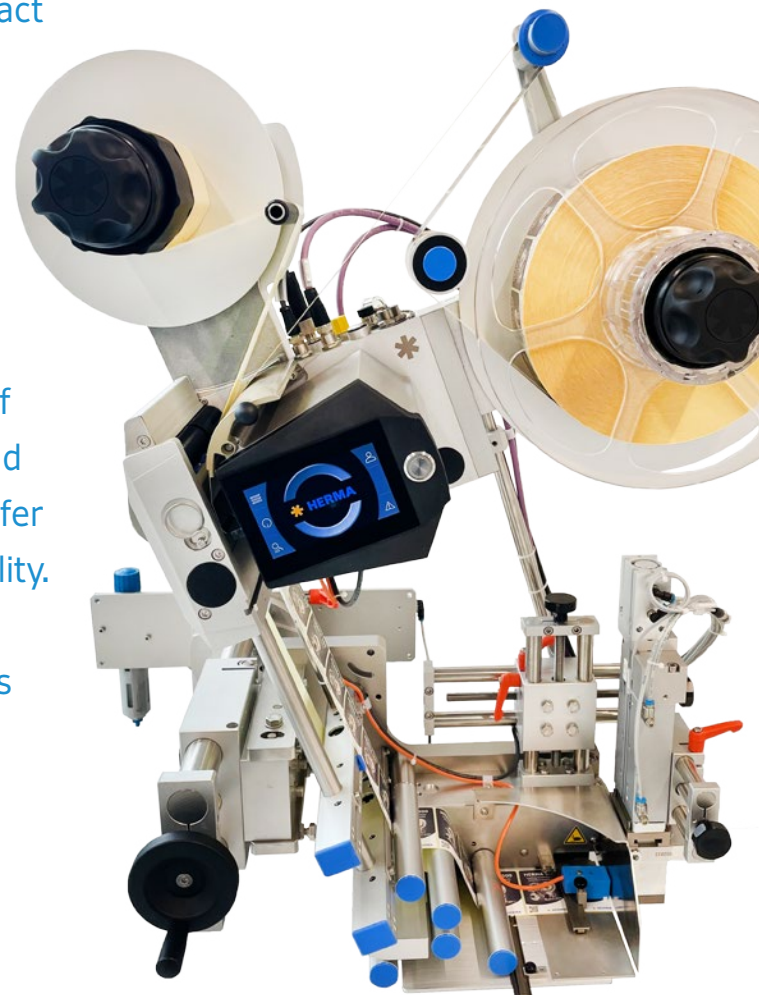

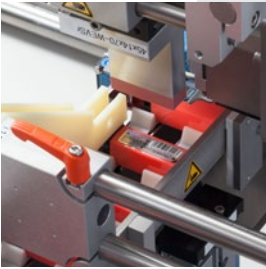

### Benefits at a glance

- Ideal for precise labeling of cosmetic products with decorative labels
- High-precision application of functional labels and self-adhesive functional elements
- High-performance applicator HERMA 500 with integrated control and convenient adjustment of all parameters via the integrated touchscreen
- Compact design for easy integration into production lines
- No additional control system required, integration into a higher-level machine control system on request
- On request, different printers can be integrated to print variable data

### Technical data

Labeling type:	Top/side/bottom labeling
Product specifications:	Rectangular, oval, cylindrical, largely stable in form
Label dimensions:	15 - 160 x 10 - 100 mm (W x L)
Labeling tolerance:	Up to 0.2 mm
Capacity:	Up to 70 products/minute
Power supply:	100 - 240 V AC, 400 W, 50 - 60 Hz
Compressed air supply:	6 bar
Printer:	Various hot-foil and thermal transfer printers (optional)
Components:	Attachment holder, applicator with movable peel plate, linear transfer unit with attachment holder for tamp pad
Options:	Label web stopper, pick-up cylinder, tamp pad adapted to label and product, digital position indicator, interfaces for integration into higher-level control
Note:	If optional features are chosen, the above data may vary.

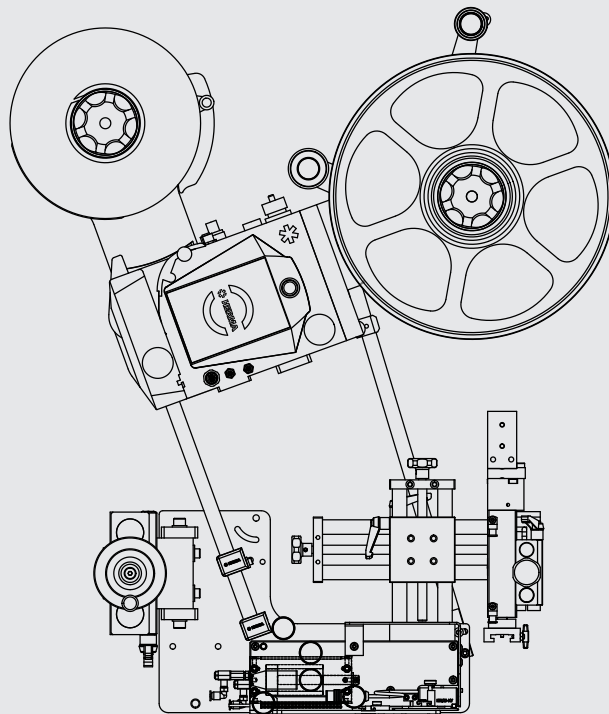

HERMA 500 MB Video

HERMA GmbH  
Labeling Machines Division

Heinrich-Hermann-Straße 14  
D-70794 Filderstadt

Tel. +49 (0) 711 / 7702-2012

www.herma-labeler.com  
machines@herma.com