

REVISION HISTORY			
REV	DESCRIPTION	DATE	APRD
1	REDESIGNED BLOCK-MOUNT, WASHER-PIN LOCKING, PIN - LOCKING	9/17/2004	BCB

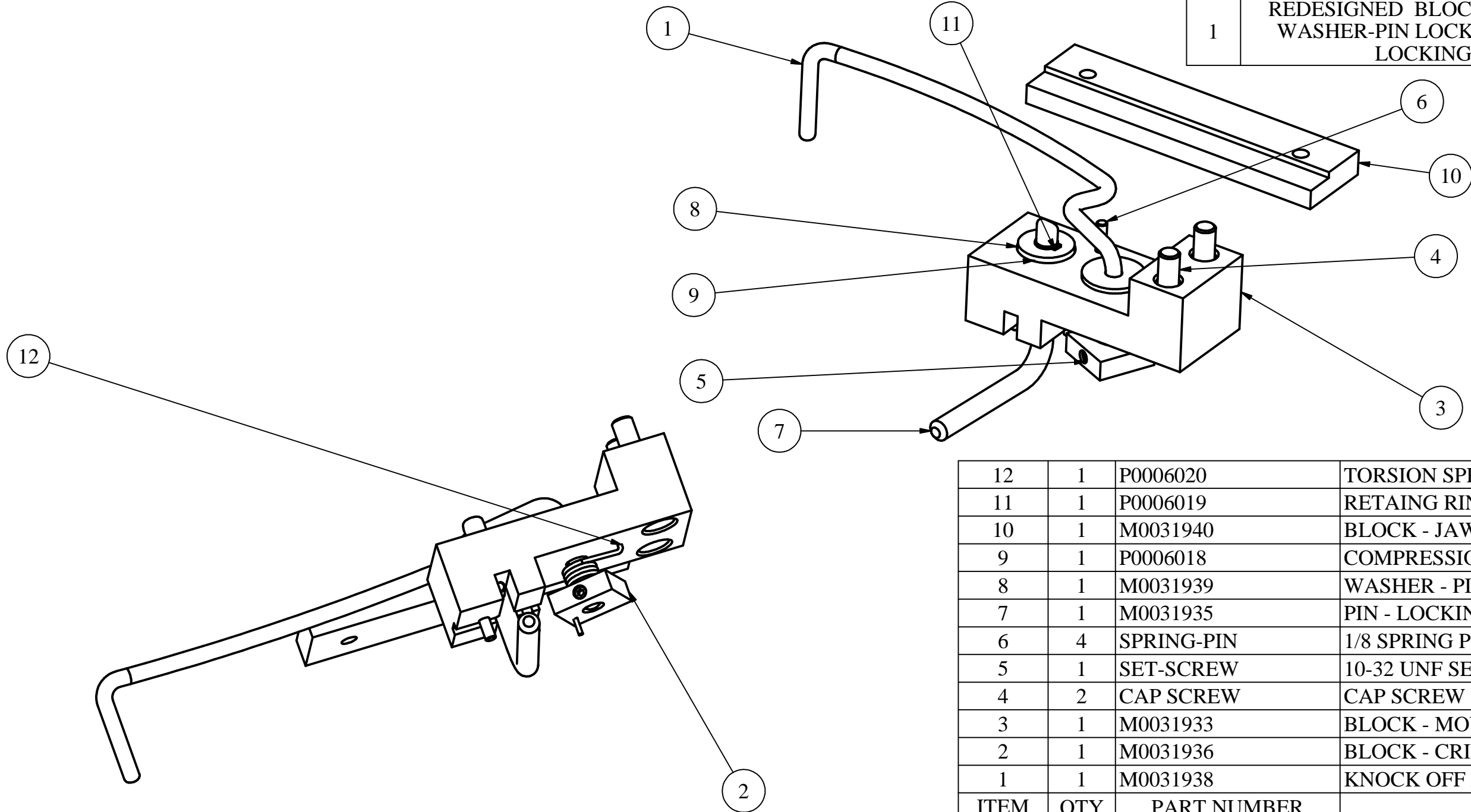

12	1	P0006020	TORSION SPRING - KNOCK OFF
11	1	P0006019	RETAING RING - LOCKING PING
10	1	M0031940	BLOCK - JAW REACTION
9	1	P0006018	COMPRESSION SPRING
8	1	M0031939	WASHER - PIN LOCKING
7	1	M0031935	PIN - LOCKING
6	4	SPRING-PIN	1/8 SPRING PIN
5	1	SET-SCREW	10-32 UNF SET SCREW
4	2	CAP SCREW	CAP SCREW 1/4-20
3	1	M0031933	BLOCK - MOUNTING
2	1	M0031936	BLOCK - CRIMPING
1	1	M0031938	KNOCK OFF ARM ASM
ITEM	QTY	PART NUMBER	DESCRIPTION

Parts List

This drawing and all information herein is the property of Rennco, Inc. and is confidential and must not be made public or reproduced by any means unless authorized by Rennco, Inc. and is subject to return upon demand.

RENNCO

PACKAGING MACHINES AND SYSTEMS

23721 M60 W. - HOMER, MI 49245

PHONE: (517)568-4121 FAX: (517)568-4799 - WWW.RENNCO.COM

MATERIAL:
NOTED ABOVE

UNLESS OTHERWISE SPECIFIED TOLERANCES:
ANGULAR $\pm 1^\circ$;
LINEAR .X \pm .10; .XX \pm .01; .XXX \pm .005
FRACTIONAL TOLERANCES:
LOCATION $\pm 1/32$ ";
HOLE DIA $+1/64$,-0"
BREAK ALL CORNERS R1/32"
SHEET METAL: BEND RADIUS 1/32"

FINISH:
NONE

ENG BY:
BCB

DRAWN BY:
BCB

CHECKED BY:

W.O. NO.:

DATE DRAWN:
9/10/2004

DATE APRV:

DESCRIPTION:

KNOCK OFF ASM

SCALE: NONE

QTY REQD: 1

DRAWING NUMBER:

M0031941

SHEET

1